

- EST. 1840 -



CLIFTON ARMS  
HOTEL



YOUR CONFERENCE  
YOUR  
CLIFTON ARMS HOTEL

[CLIFTONARMSLYTHAM.COM](http://CLIFTONARMSLYTHAM.COM)



Conferences, business meetings and special events at the Clifton Arms Hotel all have the advantages of modern technology, combined with the excellence of the food and service offered to all our guests.

Whether visiting the Clifton Arms Hotel for the first time as a conference delegate or attending a presentation, you will always be greeted with a warm welcome.

Whatever your requirements, formal or informal, conference, seminar, meeting, training event, interviews – we have a choice of versatile conference suites and we take pleasure in providing you with our four star service from your initial enquiry to the close of the event.

---

West Beach, Lytham, Lancashire, FY8 5QJ

T: 01253 739898  
functions@cliftonarmslytham.com

CLIFTONARMSLYTHAM.COM



---

*A perfect setting*

## DAY DELEGATE PACKAGE



This rate includes conference room hire, bottled water, stationery, screen, projector, three servings of tea/coffee with croissants on arrival, mid-morning homemade shortbread biscuits and cakes in the afternoon. A delicious two course buffet lunch will be served in either our restaurant or function suite.

*£39.00 per person*

## 24 HOUR DELEGATE PACKAGE



This rate includes the Day Delegate Package along with overnight accommodation, table d'hote dinner in either the restaurant or a private dining room and our fantastic full Lancashire breakfast.

Please note that special corporate rates can be negotiated and we can tailor packages to suit your individual requirements – Contact Us!

*£165.00 per person*

---

*A perfect setting*

## THE BALLROOM



Grand events deserve a grand setting. From corporate launches to *conferences* and *industry awards*. Our Ballroom offers the perfect venue for it all – offering the space and *flexibility* to meet your needs, whatever the occasion.

### SUGGESTED ROOM PLAN

#### Cabaret Style

ROOM TOTAL: UP TO 64 SEATED

ROOM SIZE: 15.6M X 17.2M



---

*A perfect setting*

# THE BALLROOM



## SUGGESTED ROOM PLANS

### Theatre Style

ROOM TOTAL: UP TO 100 SEATED      ROOM SIZE: 15.5M X 17.0M

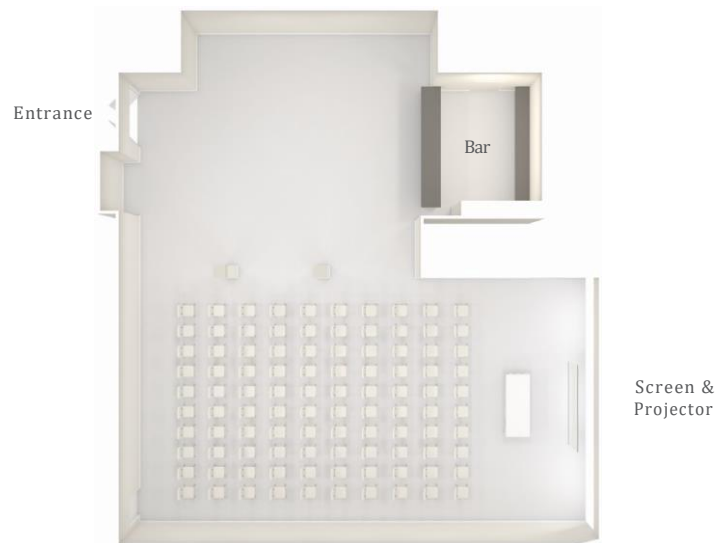

### Horseshoe Style

ROOM TOTAL: UP TO 64 SEATED      ROOM SIZE: 15.5M X 17.0M



## THE CLIFTON SUITE



The views across Lytham Green from the Clifton Suite are *stunning*, and the setting within is just as *impressive*. Tastefully decorated and well equipped, this is a *versatile space* that's just as fitting for *meetings*, drinks receptions and networking events.

### SUGGESTED ROOM PLANS

#### Boardroom Style

ROOM TOTAL: UP TO 22 SEATED

ROOM SIZE: 12M X 5.5M

Talbot Suite ↑ Screen & Projector

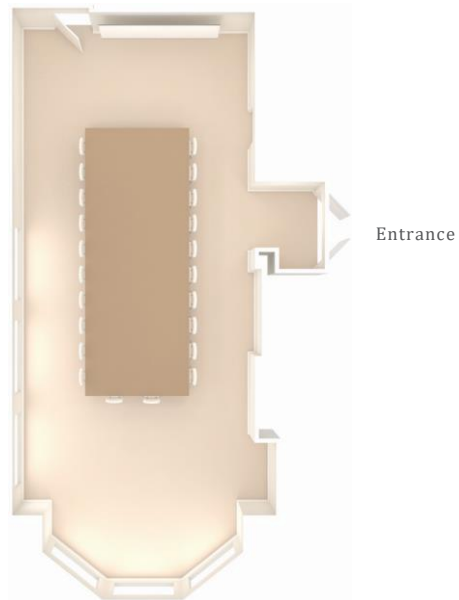

---

*A perfect setting*

# THE CLIFTON SUITE



## SUGGESTED ROOM PLANS

### Theatre Style

ROOM TOTAL: UP TO 48 SEATED

ROOM SIZE: 12M X 5.5M

Talbot Suite ↑ Screen & Projector

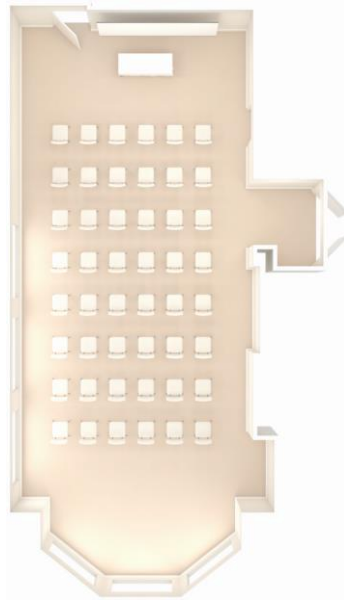

Entrance

### Horseshoe Cabaret Style

ROOM TOTAL: UP TO 48 SEATED

ROOM SIZE: 12M X 5.5M

Talbot Suite ↑ Screen & Projector

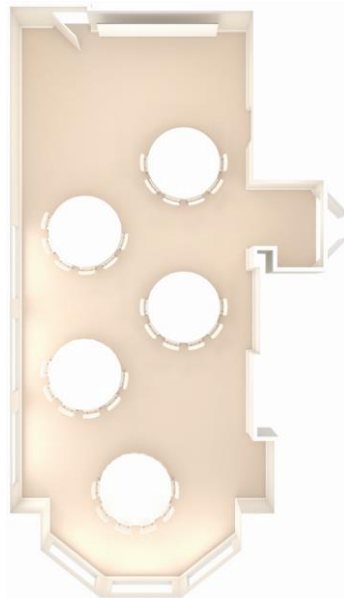

Entrance



## THE LIBRARY



Our Library is a room for *smaller meetings*, where you can enjoy *refined* surroundings and fantastic *views* across the estuary.

### SUGGESTED ROOM PLAN

#### Boardroom Style

ROOM TOTAL: UP TO 12 SEATED      ROOM SIZE: 6.5M X 4.5M

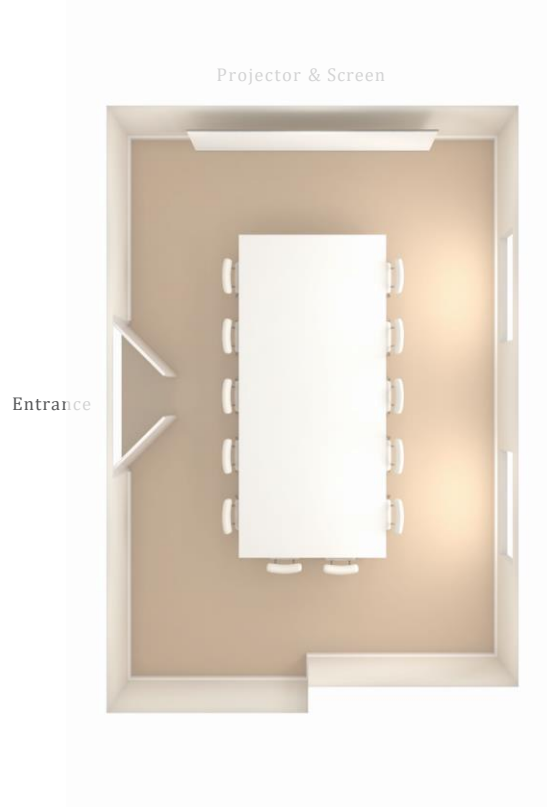

---

*A perfect setting*

## THE TALBOT SUITE



Our Talbot Suite is a space made for the *hubhub* of networking *events* and smaller conferences. With its own private bar, it's ready to *welcome* your guests.

### SUGGESTED ROOM PLAN

#### Informal Style

ROOM TOTAL: UP TO 30 SEATED

ROOM SIZE: 9.5M X 13M

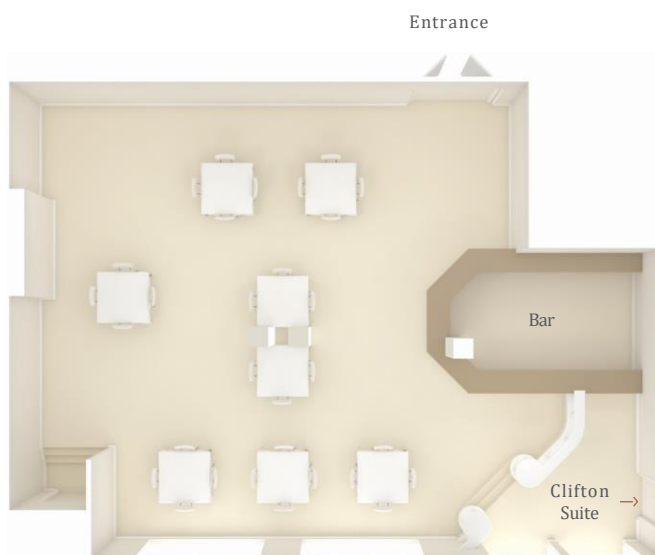

---

*A perfect setting*